

Condor Instructions

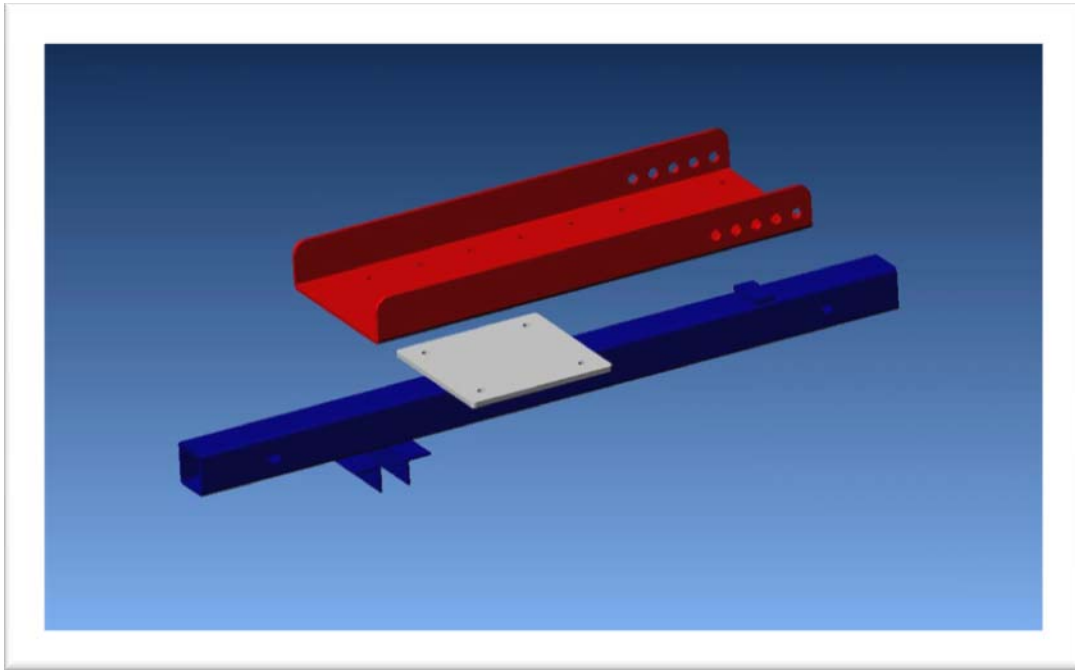

When you unpack your CONDOR un-pin all the pieces so the base plate looks similar to the one pictured above. Now unpack the front section of the trailer. Arrange the front section of the trailer with the base plate by placing the end of the base plate with the 5 pivot holes with the end of the front end with the 1" tab an .5" hole. See picture above

Align the mounting plate with the 4 holes with the condor base plate. The second and fourth set of holes from the front of the base plate should be the holes that line up with the mounting plate.

Using the 4 - 5/16" bolts and nylock nuts (included in your trailer hardware) secure the base plate to the mounting plate. The 2 pieces should line up as shown in the picture to the right.

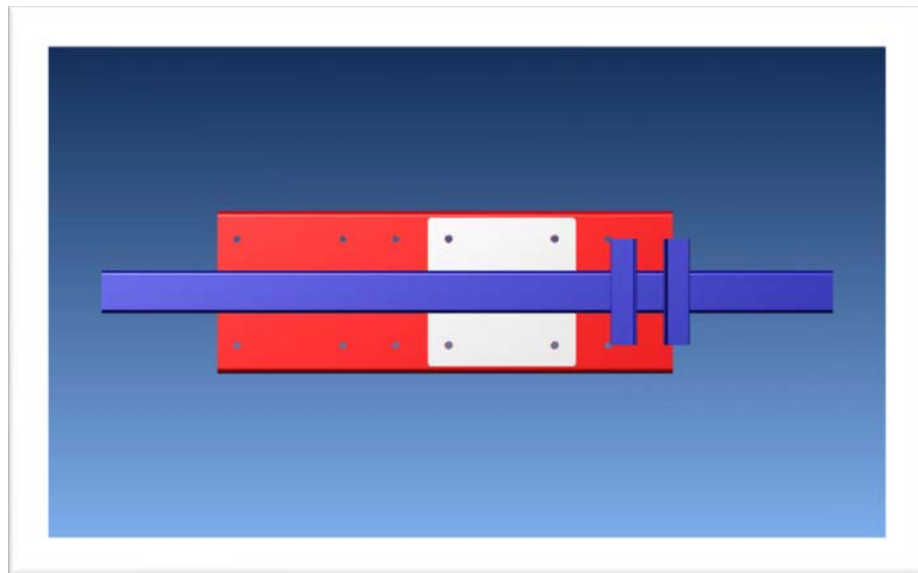

Now that the base plate is secured to the front end of the trailer, put the condor cradle and stop back using the pins you took out when you removed them. Now you can adjust the cradle to accommodate you front tire. When the cradle is properly adjusted the bottom of the pivot should be close but not touching the base plate. This will keep constant forward pressure on the wheel keeping it secure in the chock.

For more information see the condor website www.condor-lift.com or give them a call at 815-754-7418